

# Route 6 Outer Cape Complete Streets Study

Eastham, Wellfleet, and Truro

February 8, 2019

# Introduction



- MassDOT Project Manager
  - Pam Haznar, P.E. (District 5 Project Development Engineer)
- Michael Baker International
  - Kate Maker, P.E.
  - Tom Roach, P.E.

# Project Limits and Goals

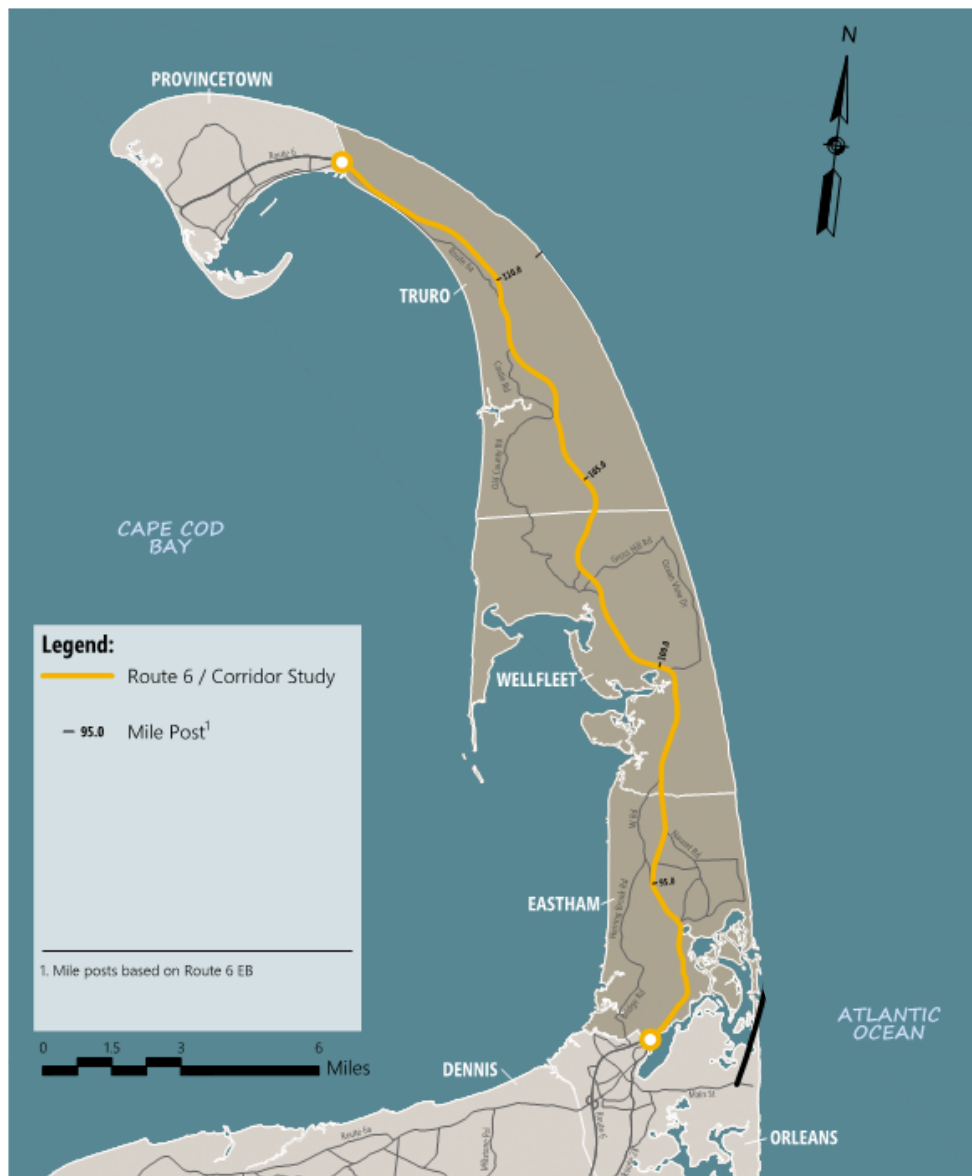

# Project Limits and Goals



# Prior Studies Reviewed



Author	Study/Report Name	Month	Year
Cape Cod Commission	2009 Transportation Safety Report Eastham: Route 6/Brackett Road Sandwich: Route 6/Route 130 (Exit 2) (Westbound & Eastbound Ramps)	May	2009
National Park Service / Cape Cod National Seashore	CCNS Integrated Bicycle Plan	N/A	2010
Cape Cod Commission	Wellfleet: Route 6 Safety Study	December	2012
Cape Cod Commission	Complete Streets/Living Streets: A Design Manual for Cape Cod	October	2012
Cape Cod Commission	Closing the Gap	N/A	2013
Cape Cod Commission	Barnstable County High Crash Locations	June	2014
Cape Cod Commission	Route 6 Corridor Study: North Eastham – South Wellfleet	February	2015
Cape Cod Commission	Cape Cod Bicycle & Pedestrian Safety Plan	September	2015
Cape Cod Commission	Town of Wellfleet Road Safety Audit, Route 6 at Main Street	June	2016
Cape Cod Commission	Regional Transportation (RTP) Plan	N/A	2016
Cape Cod Commission	Eliminating Transit Barriers	October	2016
Cape Cod Commission	Outer Cape Cod Bike Plan	N/A	2017
Cape Cod Commission	Traffic Counting Report	N/A	2017
Cape Cod Commission	Complete Streets for Eastham	N/A	2018

# Project Segments





# Eastham (Segment 1)

## Prior Study Themes

- Additional Safe Pedestrian Accommodations
- Low Stress Bike Facilities
- Intersection Safety Improvements
- Potential Bike Connectors
- Bus Stop Improvements



2/11/2019



# Eastham (Segment 1)



TYPES OF COLLISION	SYMBOLS	SEVERITY	TRAFFIC CONTROL
<ul style="list-style-type: none"> <li>←←← REAR END</li> <li>←→→ HEAD ON</li> <li>←←← SIDE SWIPE</li> <li>←←← OUT OF CONTROL</li> <li>←→→ LEFT TURN</li> <li>←→→ RIGHT ANGLE</li> </ul>	<ul style="list-style-type: none"> <li>← MOVING VEHICLE</li> <li>←→ BACKING VEHICLE</li> <li>▭ PARKED VEHICLE</li> <li>▭ FIXED OBJECT</li> <li>♀ PEDESTRIAN</li> <li>♂ BICYCLIST</li> <li>♂ ANIMAL</li> </ul>	<ul style="list-style-type: none"> <li>○ FATAL ACCIDENT</li> <li>○ INJURY ACCIDENT</li> </ul>	<ul style="list-style-type: none"> <li>Ⓢ TRAFFIC SIGNAL</li> <li>Ⓢ STOP SIGN</li> <li>▽ YIELD SIGN</li> </ul>

## Road Safety Audit Orleans Rotary

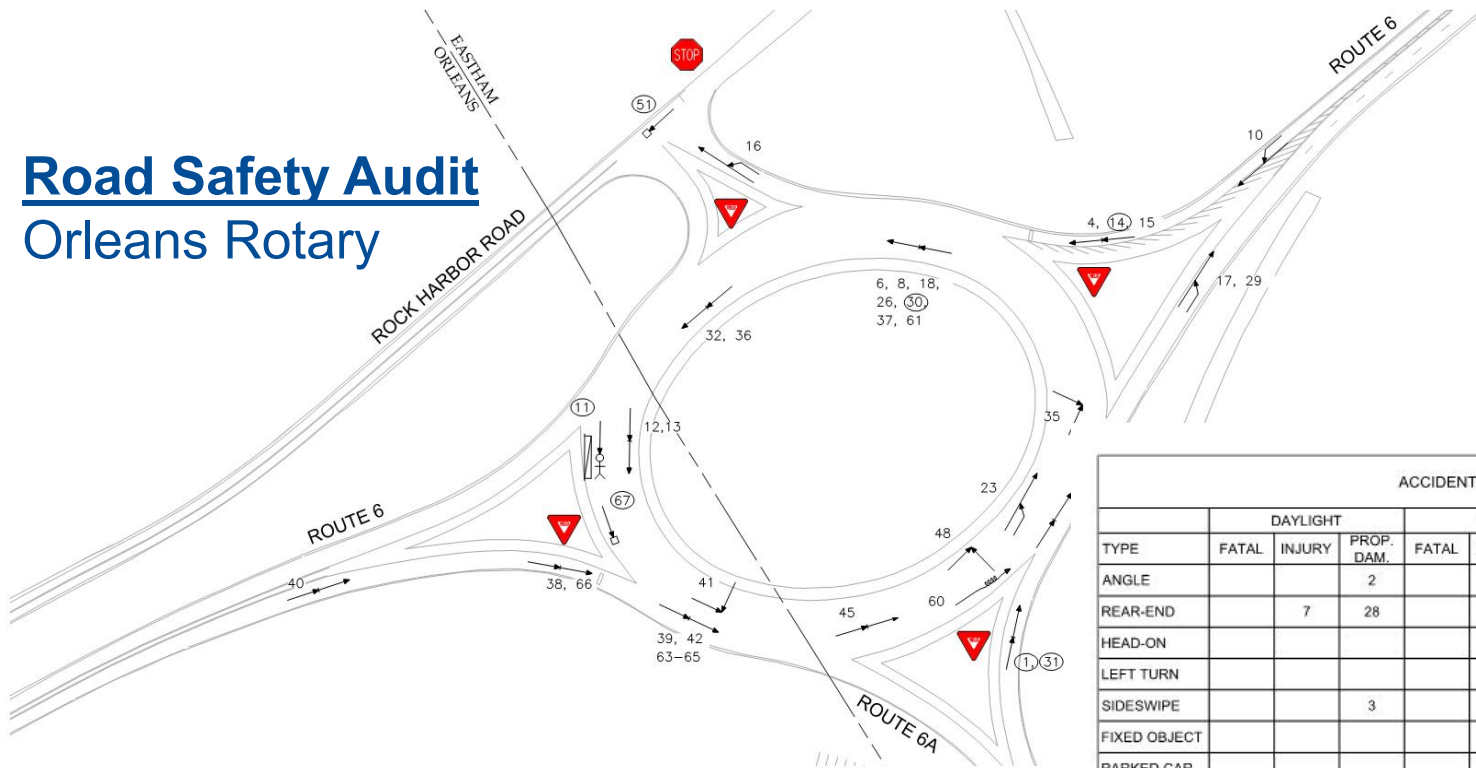

ACCIDENT SUMMARY										
TYPE	DAYLIGHT			NIGHT			TOTALS			
	FATAL	INJURY	PROP. DAM.	FATAL	INJURY	PROP. DAM.	FATAL	INJURY	PROP. DAM.	TOTAL
ANGLE			2			1			3	3
REAR-END		7	28		1	3		8	31	39
HEAD-ON										
LEFT TURN										
SIDESWIPE			3		1	2		1	5	6
FIXED OBJECT					2			2		2
PARKED CAR										
OTHER					1			1		1
<b>TOTALS</b>		<b>7</b>	<b>33</b>		<b>5</b>	<b>6</b>		<b>12</b>	<b>39</b>	<b>51</b>

NOTE: CRASH SUMMARY 2014 - 2016



# Eastham (Segment 1)



TYPES OF COLLISION	SYMBOLS	SEVERITY	TRAFFIC CONTROL
REAR END HEAD ON SIDE SWIPE OUT OF CONTROL LEFT TURN RIGHT ANGLE	MOVING VEHICLE BACKING VEHICLE PARKED VEHICLE FIXED OBJECT PEDESTRIAN BICYCLIST ANIMAL	FATAL ACCIDENT INJURY ACCIDENT	TRAFFIC SIGNAL STOP SIGN YIELD SIGN

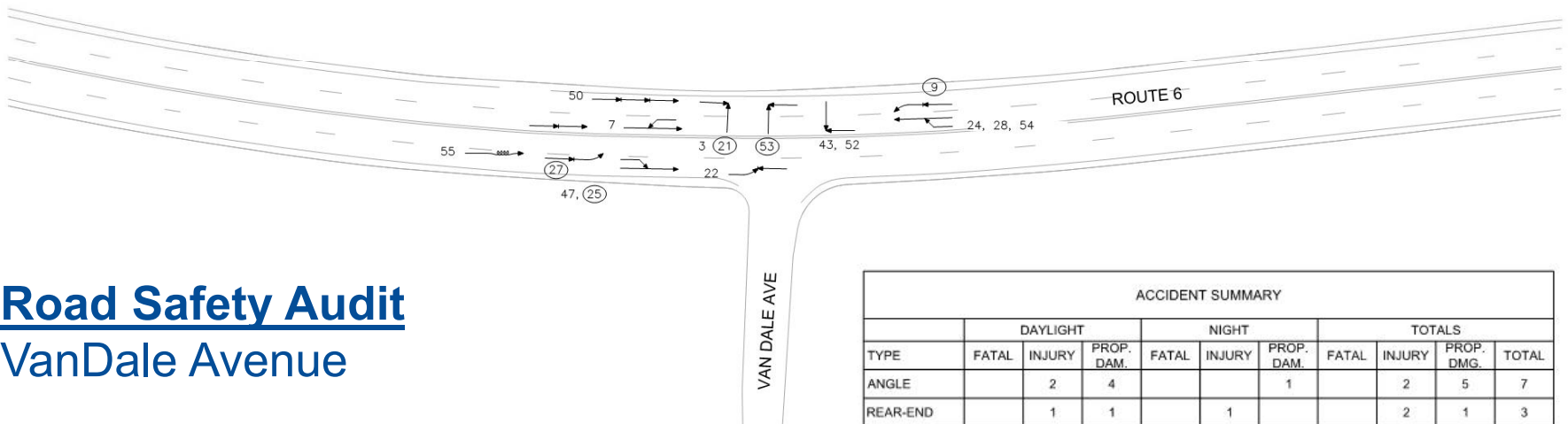

## Road Safety Audit VanDale Avenue

ACCIDENT SUMMARY										
TYPE	DAYLIGHT			NIGHT			TOTALS			
	FATAL	INJURY	PROP. DAM.	FATAL	INJURY	PROP. DAM.	FATAL	INJURY	PROP. DMG.	TOTAL
ANGLE		2	4			1		2	5	7
REAR-END		1	1		1			2	1	3
HEAD-ON										
LEFT TURN										
SIDESWIPE		1	4						4	5
FIXED OBJECT						1				1
PARKED CAR										
OTHER										
TOTALS		8	9		1	2		4	10	16

NOTE: CRASH SUMMARY 2014 - 2016

# Wellfleet (Segment 2)

## Prior Study Themes

- Safe Pedestrian Accommodations
- Low Stress Bike Facilities
- Intersection Safety Improvements
- Potential Bike Connectors
- Bus Stop Improvements

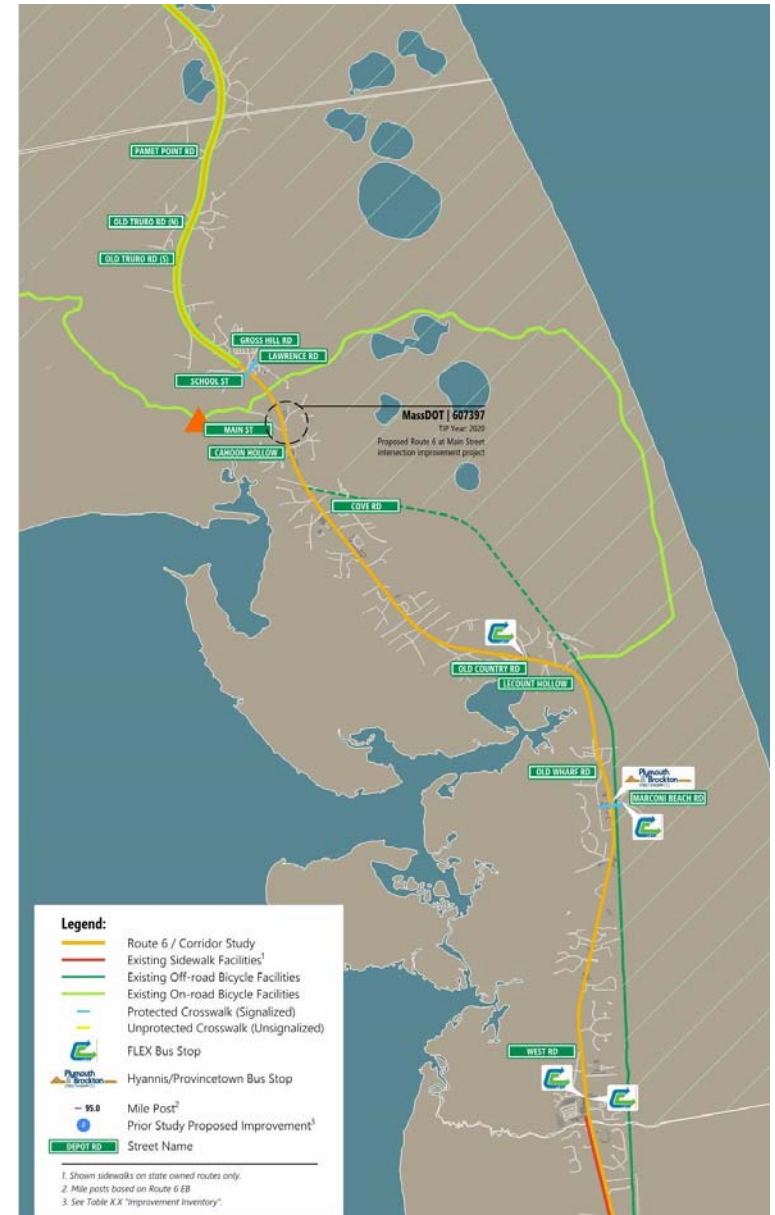

# Truro South (Segment 3)



## Prior Study Themes

- Safe Pedestrian Accommodations
- Low Stress Bike Facilities
- Intersection Safety Improvements
- Potential Bike Connectors
- Bus Stop Improvements





# Truro North (Segment 4)

## Prior Study Themes

- Desire for low stress bike/ped accommodations
- Minimal shoulders and high speeds
- Route 6 is a barrier for biking
- Road diet candidate



## Next Steps

- Perform the Road Safety Audits
- Develop a menu of short term and long term implementable solutions
- Coordinate and solicit input with individual stakeholders

